

FIRST FLOOR
622 sq.ft. (57.8 sq.m.) approx.

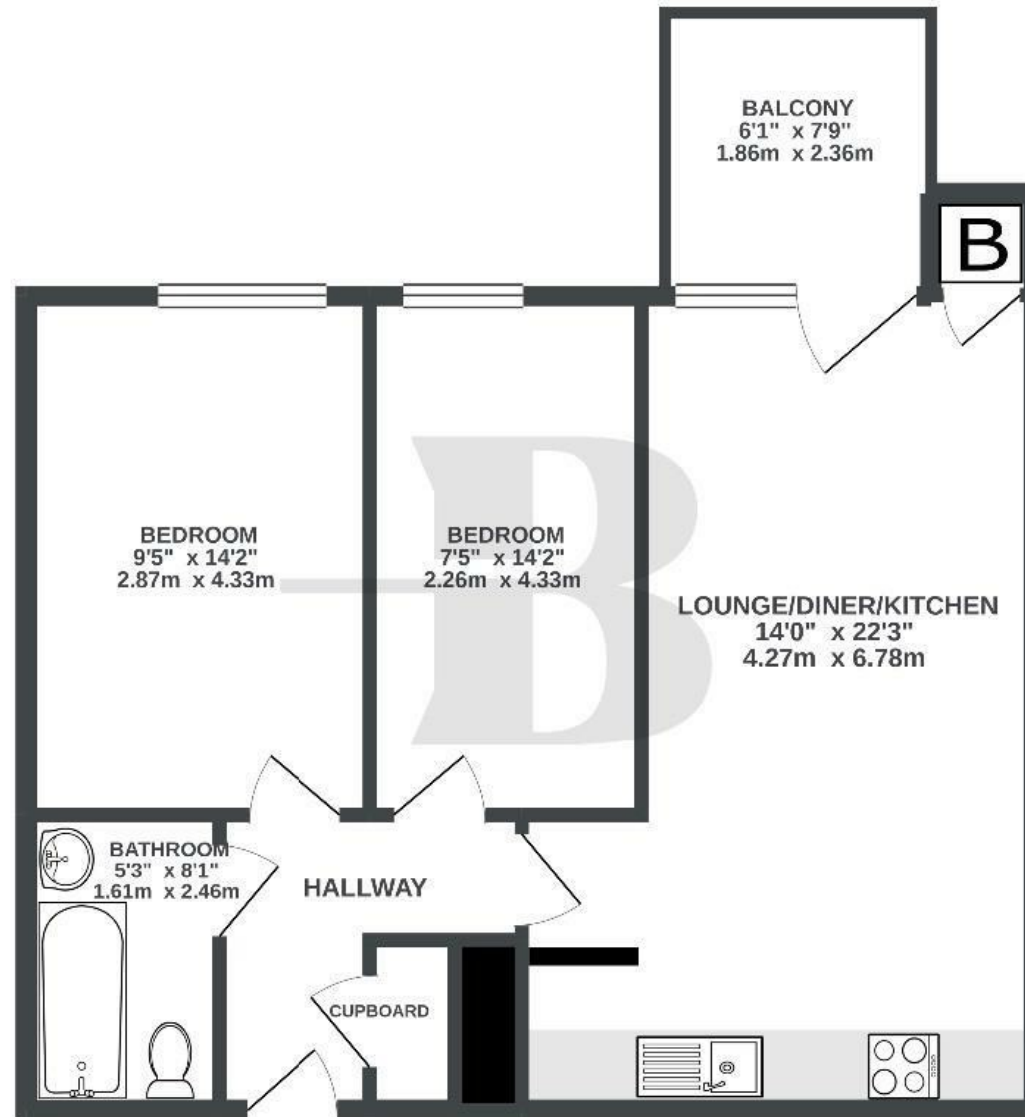

TOTAL FLOOR AREA : 622 sq.ft. (57.8 sq.m.) approx.

Whilst every attempt has been made to ensure the accuracy of the floorplan contained here, measurements of doors, windows, rooms and any other items are approximate and no responsibility is taken for any error, omission or mis-statement. This plan is for illustrative purposes only and should be used as such by any prospective purchaser. The services, systems and appliances shown have not been tested and no guarantee as to their operability or efficiency can be given.
Made with Metropix ©2022

Boardwalk

Backfields

, BRISTOL

£

£135,000



BS2 8AQ

zzz

2 Bedrooms



1 Bathrooms

"I have lived in this property for 3 years, we have good community and we speak to each other a lot. Most people who live here are professional working around city centre or BRI. Livewest is a really good housing association, they repair any faults within 24 hours. Apart from any plumbing and electric issues in the house they look after all other major issues. Rent is really low on other half of the property."

"If I had the money I would definitely keep this flat as it's a great location as there are loads of restaurants and bars around. The area has seen increase in demand due to the location and I'm sure it will keep improving in the future. Never had any issues from people living in the flat"

